

Vector Frame Kit 06

VF-K-06

Stand apart from the competition with a clean, sophisticated 10' x 10' or 10' x 20' Vector Frame™ exhibit kit. These graphic mural kits feature square-corner 50mm extrusion frames and push-fit fabric graphics that cover the entire frame. Vector Frame Essential kits are easy to assemble and disassemble.



features and benefits:

- 50mm silver extrusion frame
- Single-sided SEG dye-sublimated fabric graphics
- Easy step-by-step instructions
- Kit includes frame, nine fabric graphics, five 120 watt floodlights, and two wheeled molded cases
- Lifetime hardware warranty against manufacturer defects

dimensions:

Hardware	Graphic
<p>Assembled Unit: 220.5" w x 94.5" h x 28" d 5600mm(w) x 2400mm(h) x 711mm(d)</p>	<p>Total visual area: Panels A & I: 47.441" w x 94.5" h 1205mm(w) x 2400mm(h)</p> <p>Panels B & H: 25.787" w x 94.5" h 655mm(w) x 2400mm(h)</p> <p>Panels C & G: 39.370" w x 94.5" h 1000mm(w) x 2400mm(h)</p>
<p>Shipping</p> <p>Shipping dimensions - ships in 2 cases: 1 OCH2 case: 52" l x 30" w x 15" h 1320.8mm(l) x 762mm(w) x 381mm(h)</p> <p>1 OCE case: 40" l up to 60" l x 18" w x 18" h 1016mm up to 1524mm(l) x 457.2mm(w) x 457.2mm(h)</p> <p>Approximate shipping weight (kit with cases): 184.22 lbs / 83.5 kgs</p>	<p>Panels D & F: 13.976" w x 94.5" h 355mm(w) x 2400mm(h)</p> <p>Panel E: 45.866" w x 94.5" h 1165mm(w) x 2400mm(h)</p> <p>Please be sure to include a 2" bleed around the perimeter.</p> <p>Refer to related graphic templates for more information</p>

additional information:

<p>Graphic material: Dye-sublimated fabric</p>	<p>Lights Included: Lumina 200 120 watt floodlight, curved arm, black finish, 19.5" from end to end</p>
--	---

We are continually improving and modifying our product range and reserve the right to vary the specifications without prior notice. All dimensions and weights quoted are approximate and we accept no responsibility for variance. E&OE. See Graphic Templates for graphic bleed specifications.

Parts Included:

Code	Qty	Description
VF-K-06-A-G	x1	1205MM (47.441")W X 2400MM (94.5")H FABRIC GRAPHIC W/FEC-2 ALL SIDES
VF-K-06-B-G	x1	655MM (25.787")W X 2400MM (94.5")H FABRIC GRAPHIC W/FEC-2 ALL SIDES
VF-K-06-C-G	x1	1000MM (39.370")W X 2400MM (94.5")H FABRIC GRAPHIC W/FEC-2 ALL SIDES
VF-K-06-D-G	x1	355MM (13.976")W X 2400MM (94.5")H FABRIC GRAPHIC W/FEC-2 ALL SIDES
VF-K-06-E-G	x1	1165MM (45.866")W X 2400MM (94.5")H FABRIC GRAPHIC W/FEC-2 ALL SIDES
VF-K-06-F-G	x1	355MM (13.976")W X 2400MM (94.5")H FABRIC GRAPHIC W/FEC-2 ALL SIDES
VF-K-06-G-G	x1	1000 (39.370")W X 2400MM (94.5")H FABRIC GRAPHIC W/FEC-2 ALL SIDES
VF-K-06-H-G	x1	655MM (25.787")W X 2400MM (94.5")H FABRIC GRAPHIC W/FEC-2 ALL SIDES
VF-K-06-I-G	x1	1205MM (47.441")W X 2400MM (94.5")H FABRIC GRAPHIC W/FEC-2 ALL SIDES
IB2	x10	PH INLINE CONNECTOR
CB9-S	x4	50MM SQUARE PHCF2 CORNER BRACKET
LUM-200-ORL-B	x5	BLACK 200W HALOGEN LIGHT FIXTURE ETL APPROVED
LN-3P-LT-FXT	x5	LINEAR LIGHT FIXTURE HOLDER
F22	x8	1193MM LENGTH OF PMFC2-90 EXTRUSION - WITH IB2 LOCK HOLES BOTH SIDES
F34	x4	1155MM LENGTH OF PHFC2 EXTRUSION - WITH IB2 LOCK HOLES ONE SIDE - CAM LOCKS ONE SIDE
F36	x4	1155MM LENGTH OF PHFC2 EXTRUSION - WITH CAM LOCKS BOTH ENDS
F38	x4	900MM LENGTH OF PHFC2 EXTRUSION - WITH CAM LOCKS BOTH ENDS
F40	x4	600MM LENGTH OF PHFC2 EXTRUSION - WITH CAM LOCKS BOTH ENDS
F43	x6	300MM LENGTH OF PHFC2 EXTRUSION - WITH CAM LOCKS BOTH ENDS
PMFC2-90-CAP	x16	PMFC2-90 CAP

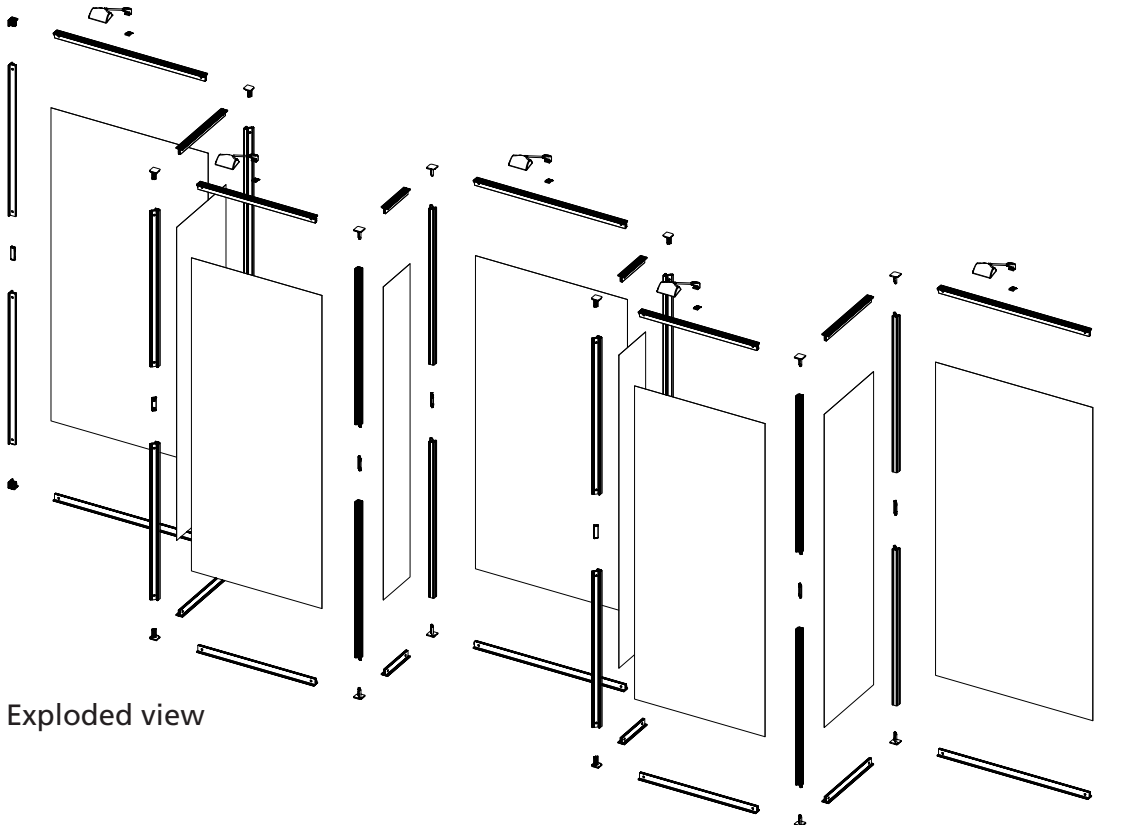

Exploded view

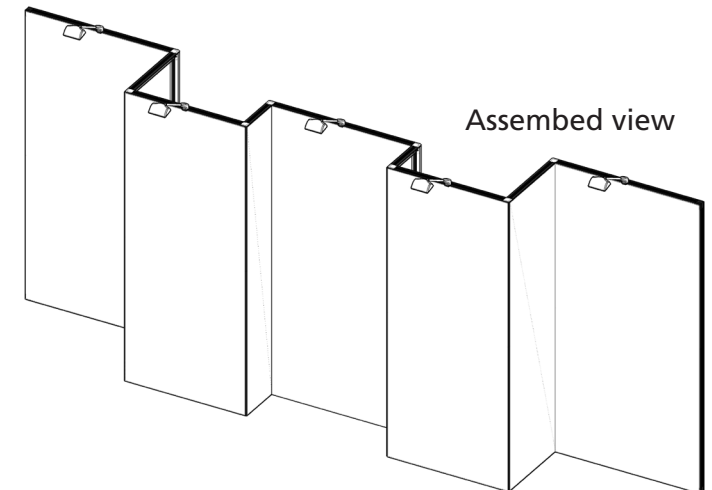

Assembled view

Step 1: Assemble Frame

Arrange pieces on the floor as shown in the diagram below. Assemble frame by securing CB9-S to the F22, F34, F36, F40 and F43s. When locking be sure to turn each cam a little bit and then go back and tighten to the proper tension. Take care to turn locks only half a turn. Slide the IB2 into the extrusion to connect sides. Tighten to the proper tension to lock extrusions together.

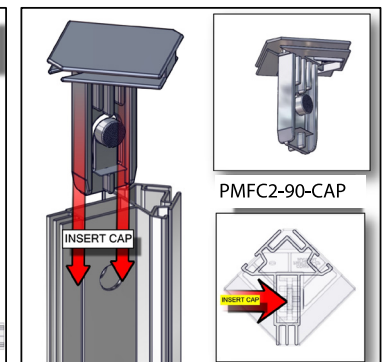
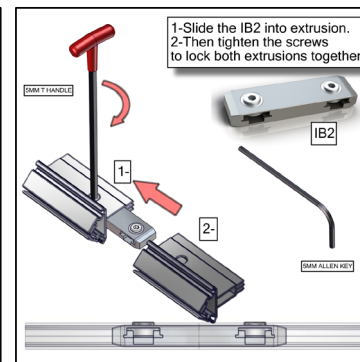
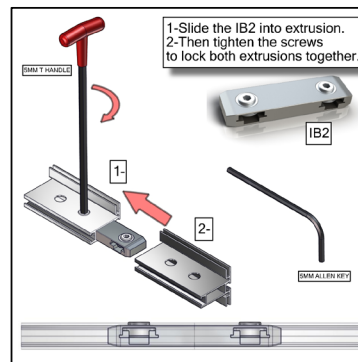
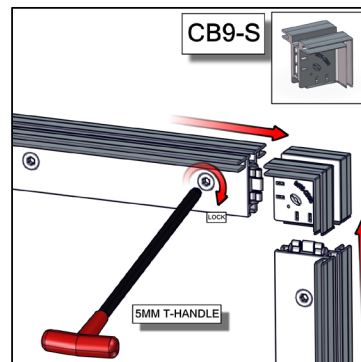
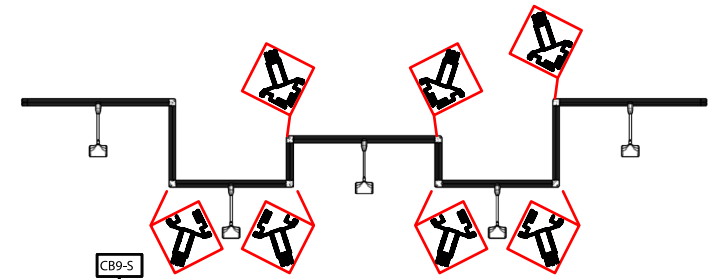
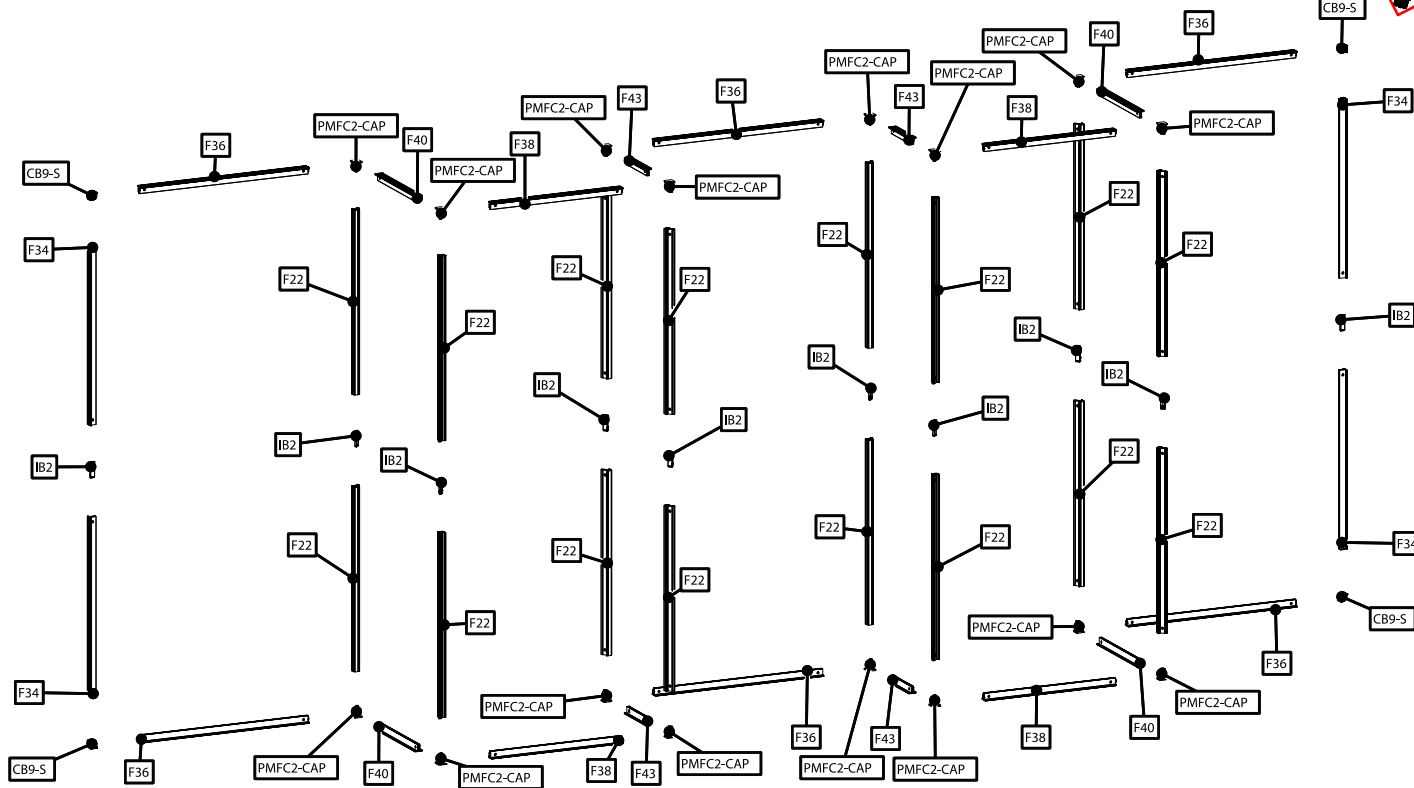

Step 2: Apply Side Panel Graphics

Install graphic(s) by pressing the FCE-2 edge of graphic into the channel of the extrusion. Start in upper left corner, go across the top and then down the sides to the bottom. Assure each graphic is tightly inserted. When taking graphics off, take care to gently pull by attached pull tab.

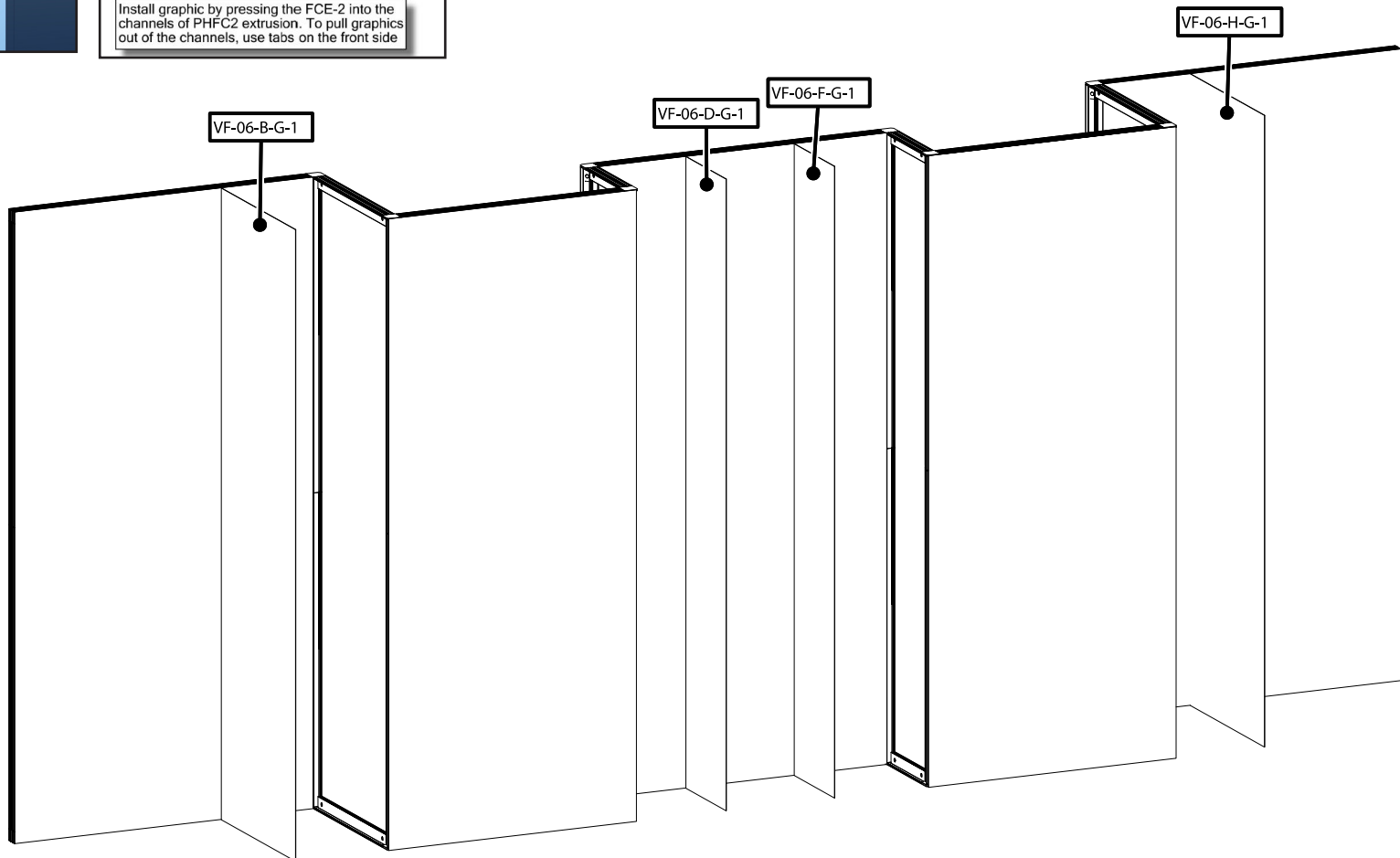
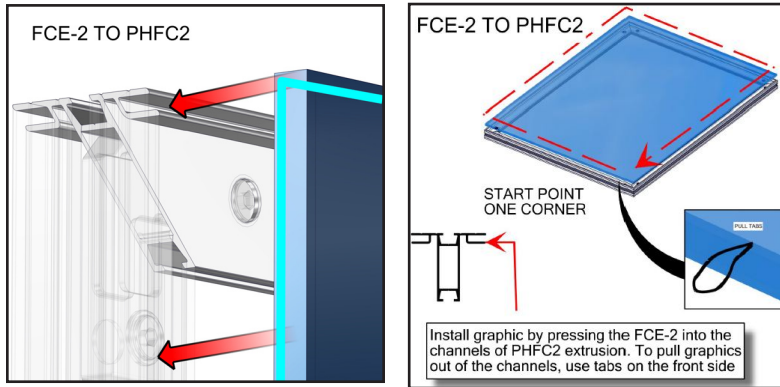
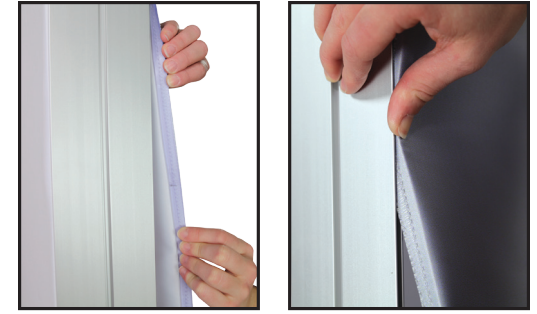

Step 3: Apply Front Panel Graphics

Install graphic(s) by pressing the FCE-2 edge of graphic into the channel of the extrusion. Start in upper left corner, go across the top and then down the sides to the bottom. Assure each graphic is tightly inserted. When taking graphics off, take care to gently pull by attached pull tab.

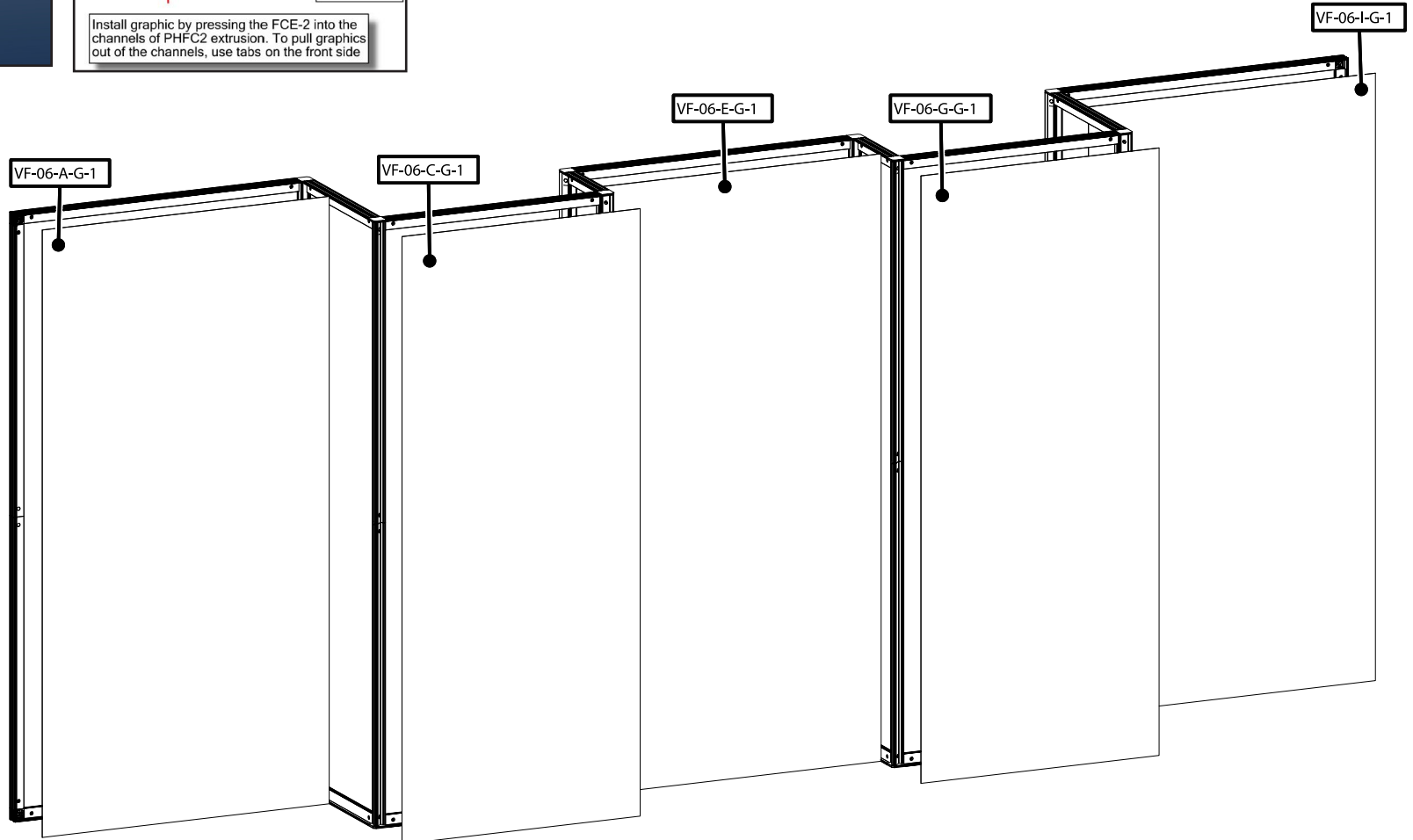
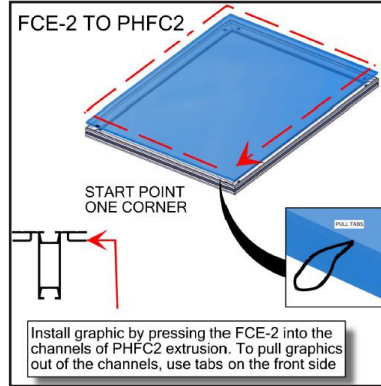
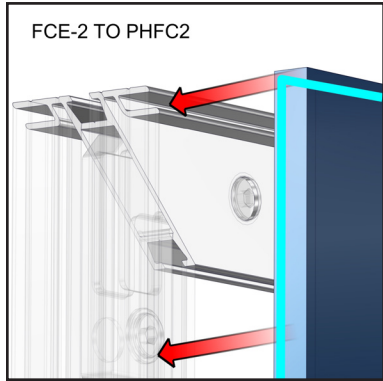
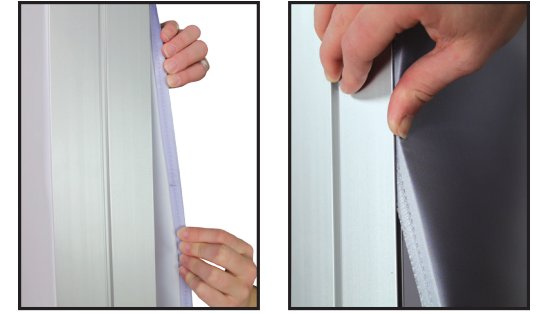

Step 4: Attach Lights

Slide light clip onto each light. Then slide light into the extrusion channel at an angle and gently lower down and repeat for each light.

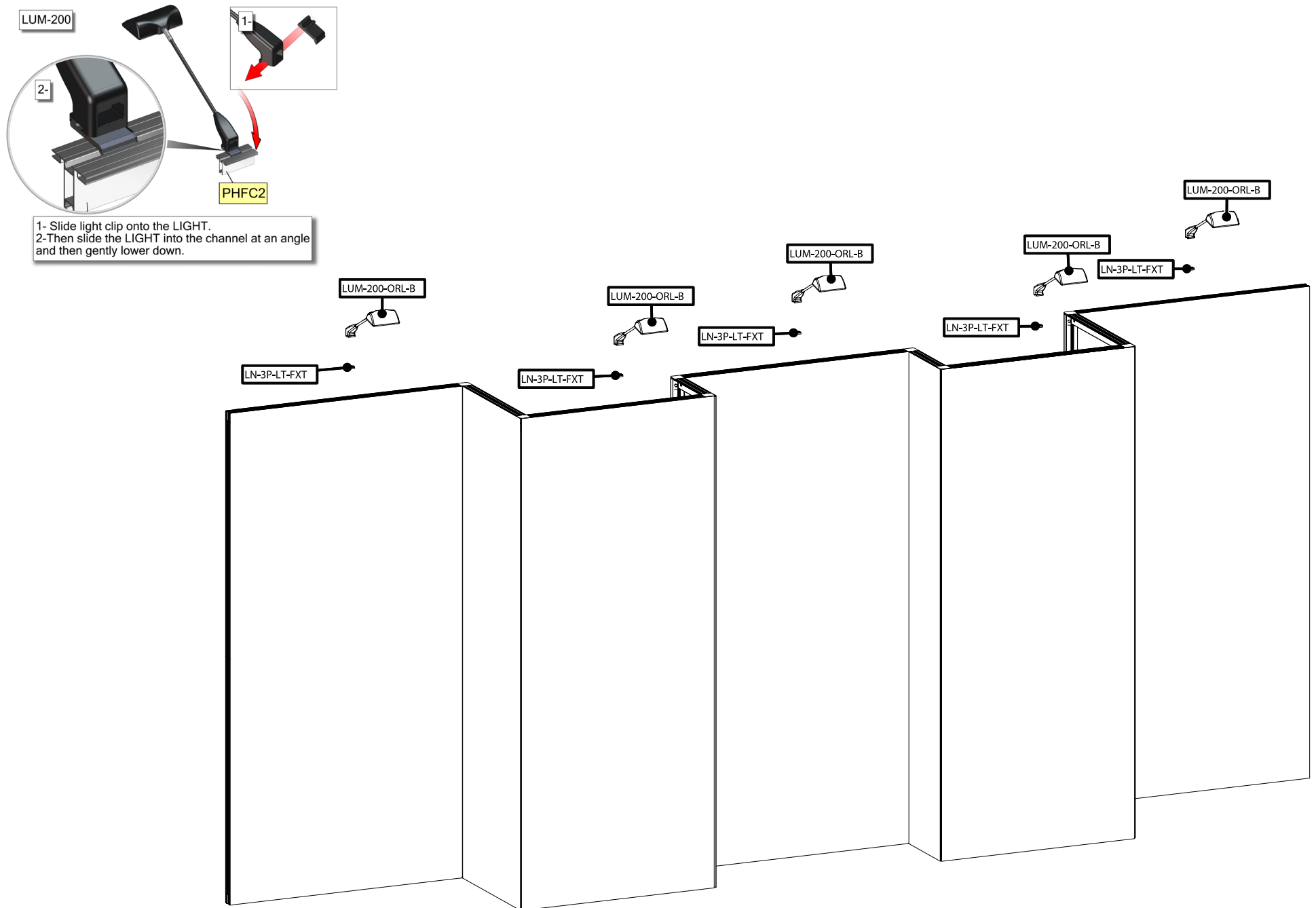

Check out these related products:



Vector Frame Kit 01



Vector Frame Kit 02



Vector Frame Kit 03



Vector Frame Kit 04



Vector Frame Kit 05



Vector Frame Kit 06



Vector Frame Kit 07



Vector Frame Kit 08